

S_{mart} **D**_{oor} **S**_{olutions}

**Reinventing Independence
One Opening at a Time**

JERI

MANUAL & GUIDE

PRODUCT LIST A

- A. JERI Base
- B. JERI TOP
- C. CONTROLLER HARNESS
- D. SENSOR MOUNT
- E. DOOR SENSOR
- F. DOOR ACTIVATOR (A&B)
- G. WIRE MOUNT (A&B)

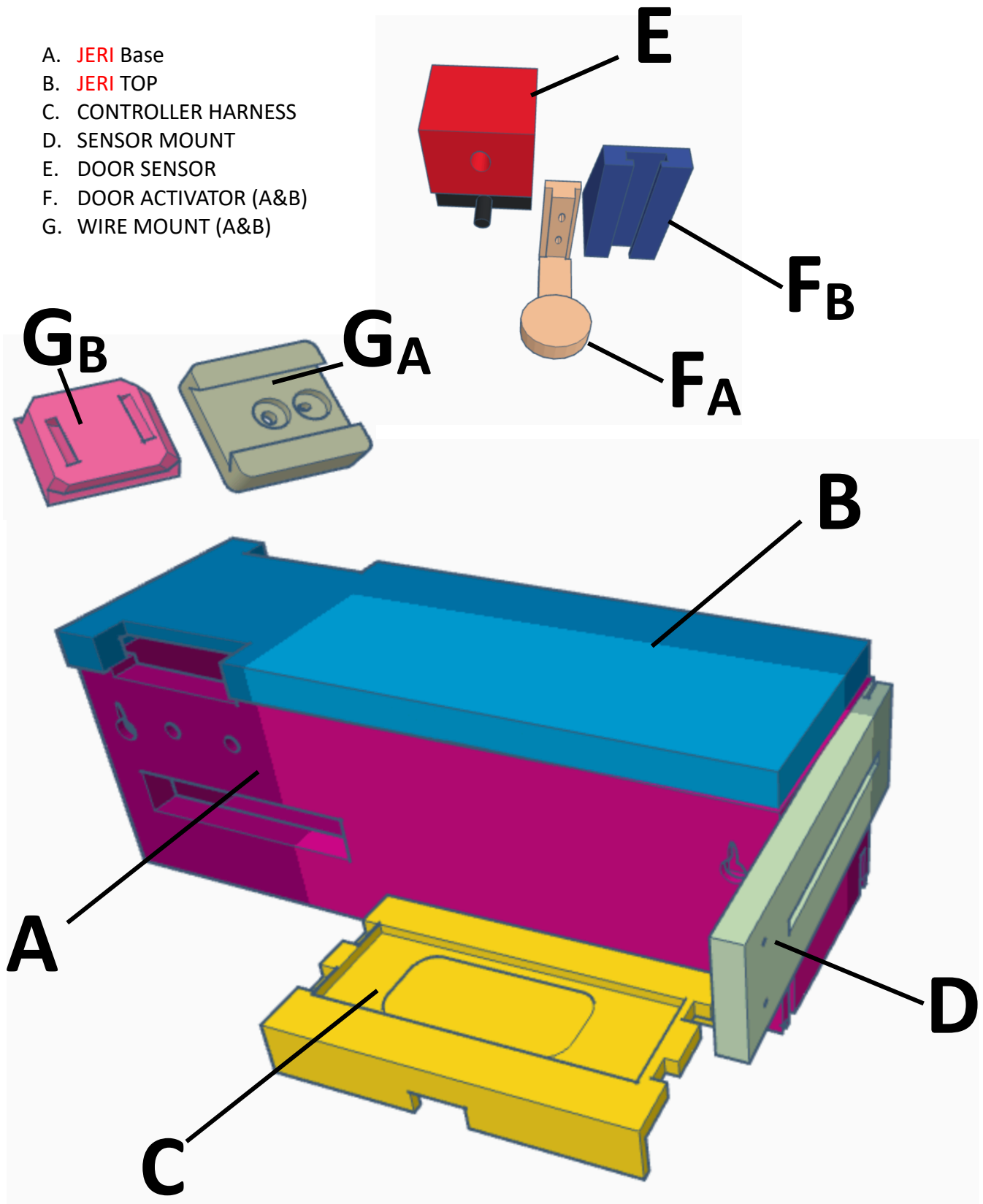

PRODUCT LIST B

- H. Controller
- I. Mounting Marking Plate
- J. Motor
- K. Flange Coupler
- L. Wheel
- M. Motor Mount
- N. Plastic Motor Mount Washer

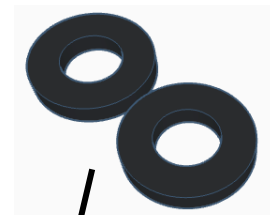
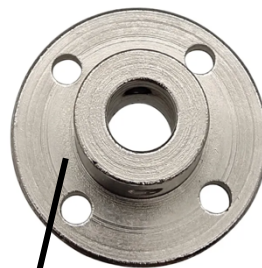
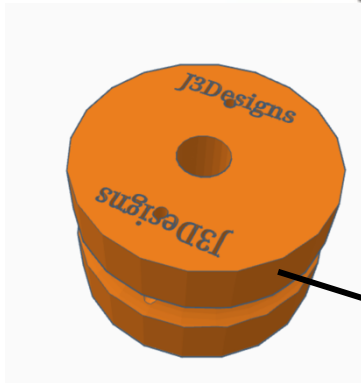
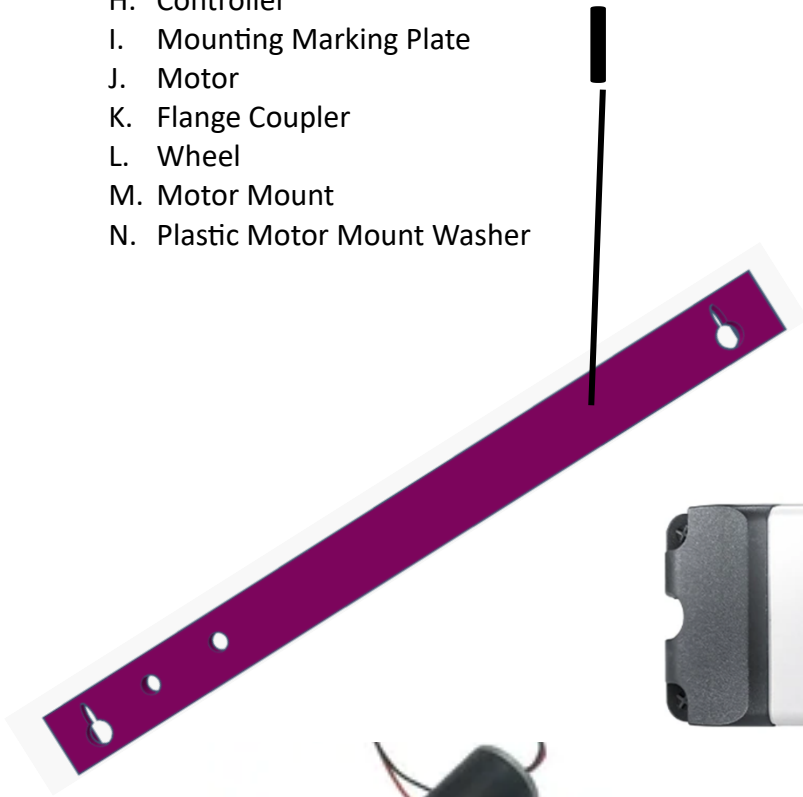

Included Hardware:

4 Threaded Rods

3 Wing Nuts

7 Mounting Screws (2x **JERI**, 2X **Motor Mount**, 1x **Door Sensor**, 2x **Door Activator**)

4 Mounting Mollies

2 Metal Washers 2X **Motor Mount**

2 Plastic Motor Mounting Washers

2 Set Screws

2 Wire Mount A

3 Wire Mount B

3 Wire Mounting Screws

2 Circular Plugs

2 Mount Plugs

1 12V 2A Power Supply

1 RF Remote Control

Additional Wire

Smart Door Solutions

WE RECOMMEND CONNECTING YOUR DEVICE TO THE WIFI PRIOR TO INSTALLATION

JERI Wifi Connection:

1. Download the Smart life Application and log in/create an account, or continue as guest.
2. Press the “+” In the top right corner of the smart life.
 - a. IF device doesn't immediately show While connected to power, remove the lid of the JERI and hold down the reset button on the controller until the light begins flashing rapidly.
3. Add Device, following the steps and connecting it to your WIFI network; Name the device according to user preference (**DOOR NAME**)
4. Rename Switch 1 **OPEN (DOOR NAME)** by long pressing the button in the Smart Life application.
5. Rename Switch 2 **CLOSE (DOOR NAME)** by long pressing the button in the smart life application.

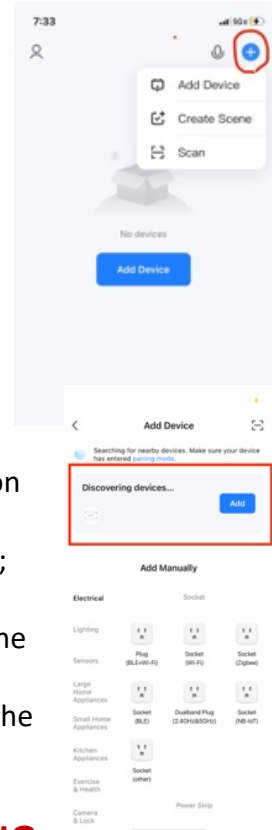

STEPS BELOW SHOULD TAKE PLACE AFTER MOUNTING

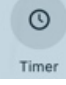
6. **SETTING INCHING DURATION**, (the time it takes for the door open or close when the button is pressed) select  from the bottom row of your device and choose **OPEN (DOOR NAME)** and select inching.
 - a. *Duration Time varies from opening to opening. Testing found times between 6-9 seconds guarantee full opening and full closing*
7. Repeat step 6, this time with **CLOSE (DOOR NAME)**
 - a. *Times between opening and closing vary so make sure to test both settings thoroughly

Connect the Accompany RF Remote Controller

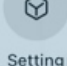
8. Select  from the bottom and choose RF remote control set up
9. Select the large Add button on the bottom and press button **A** on the remote, pointing it at your **JERI**.

- a. Once connected, choose **OPEN (DOOR NAME)** and select **State switch**, making sure that **CLOSE (DOOR NAME)** *"is not set"*.
10. Repeat step 9, this time Pressing button **B** while pointing at your **JERI**.
 - a. Make sure that **CLOSE (DOOR NAME)** is set to **State Switch** and **OPEN (DOOR NAME)** *"is not set"*.

JERI Mounting Instructions

1. Using the provided **Mounting Marking Plate**, mark the holes on the wall between the height of the top hinge but below the top of the door and **no more** than 8 inches away from the hinges on the door jamb.

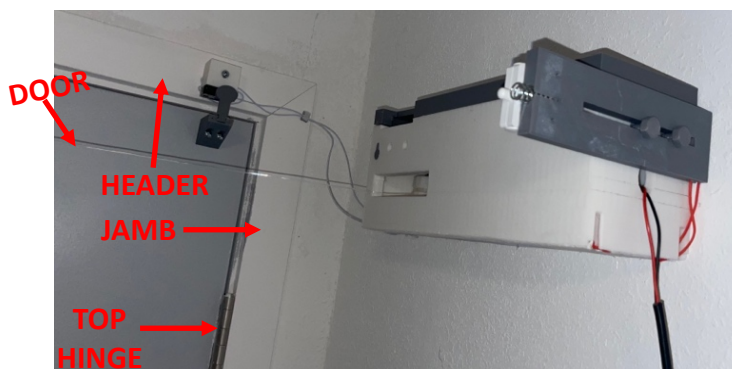

2. Drill out holes $\frac{3}{16}$ " and use the provided screws and/or mollies from **BAG1** to mount the **JERI** device.
3. REMOVE any excess foam from inside, and then place **JERI** on wall. With the **JERI** mounted, mark the holes for the **Motor Mount** and drill holes using a $\frac{3}{16}$ bit.
 - a. NOTE, **Motor Mount** is Connected to the **Motor** and located inside the **JERI**.

4. Secure the **Motor Mount** to the wall using the provided screws and washers from **BAG1**, making sure to place the **Plastic Motor Mounting Washers** between the Motor Mount and the Wall.
5. Connect Motor to Controller: RED to RED and BLACK to BLACK
6. Using the provided **wingnuts** and **threaded hex screws**, secure the **Sensor Stop** to either the front face of the **JERI** (for doors that open more than 90°) or side of the **JERI** (for doors that open to 90°)
 - i. **BE CAREFUL NOT TO OVERTIGHTEN THE WINGNUTS AND SCREWS BECAUSE IT COULD DAMAGE/BREAK the SCREW**
 - ii. ADDITIONAL mounting hardware can be found in **BAG1** in case screws get damaged
7. Secure the **Door Sensor** to the surface of the header, no more than 6 inches from the Hinge side of the jamb using provided screws using the screws found in **BAG2**.
8. Mount the **Stationary Half of the Door Activator** to the face of the door no more than **one inch** below the **Door Sensor** using the screws found in **BAG2**
9. Mount the **Mobile Half of the Door Activator** onto the **Stationary Half**, and use the provided set screws from **BAG2** to secure it into position.

NOTE: Where you set the Door Activator dictates when the power to the motor is turned off. Make sure that the JERI receives enough electricity to sufficiently close the door.

10. Mount the **Wire Mount (G_A)** to the face of the door parallel with the **Wheel** using the mount in **BAG3** along with two screws in the bag. An additional screw in **BAG3** can be used to secure the **Wire Mount (G_B)** to **Wire Mount (G_B)**.

ADDITIONAL CRITICAL MOUNTING STEPS

11. Replace middle or bottom hinge of door with provided **Spring Hinge**, making sure that the door is cocked to close whenever the door is opened.
12. Remove the latch inside the handle so that there are no restrictions that would obstruct the operation of JERI. Handle can be put back without latch inserted.

NON-ESSENTIAL MOUNTING STEPS

13. Using the plugs found in **BAG1** cover the holes that were not used to mount the **JERI** and **Sensor Mount** (4 Holes Total)
14. Use the clip found in **BAG2** to secure off any loose wire connecting the **Door Sensor** to **JERI** peeling off the double-sided tape and mounting it at the top corner of the jamb on the frame.